

ARCHITECTURAL LIGHTING

806 HOLLAND AVENUE, WILKINSBURGH

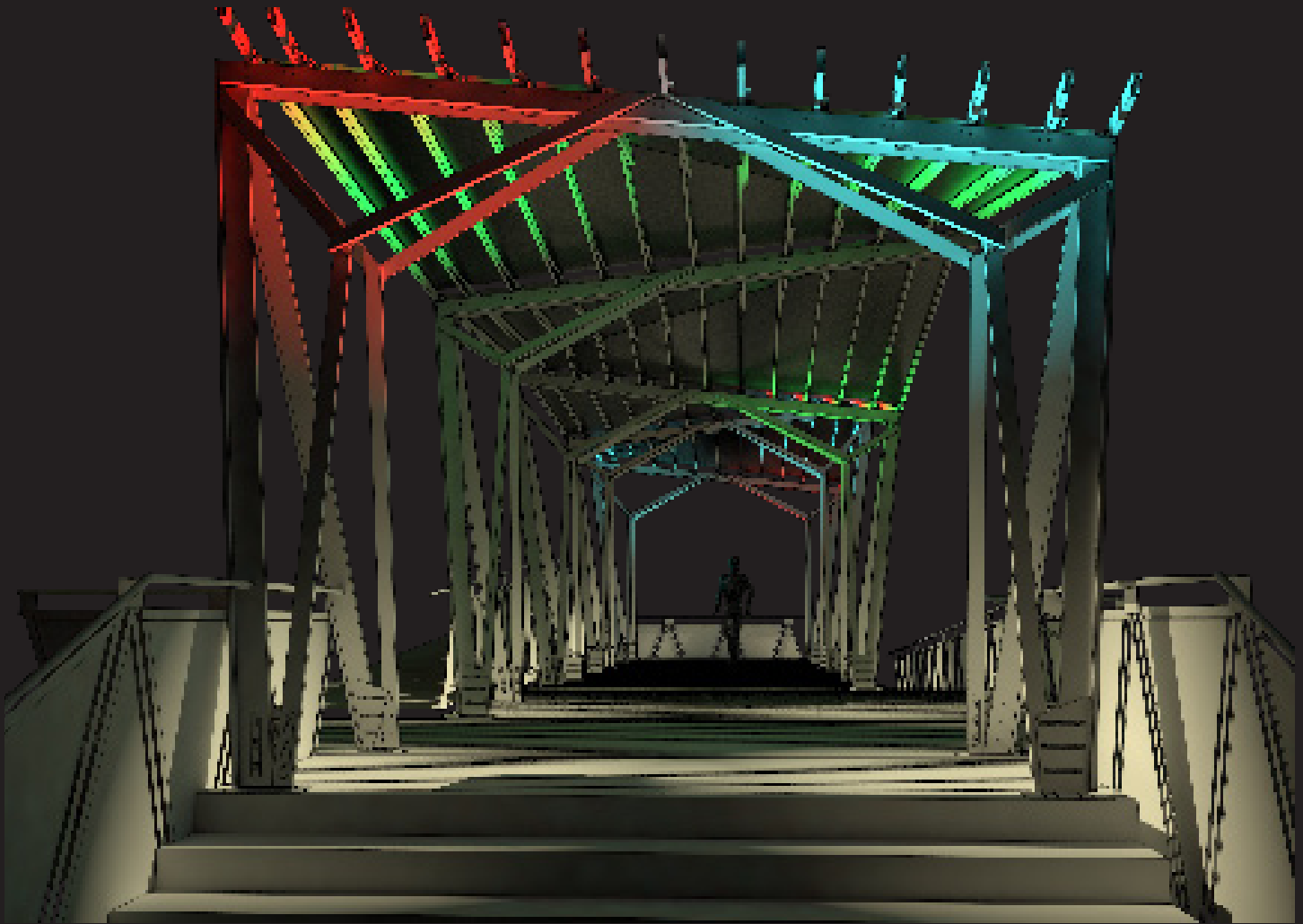

DANIEL QUAINANCE, ANDREEA MANOLANCHE,
ERIC BRUNER, DANIEL RAPOPORT, BENJAMIN HOWE,
LETO KARATSOLIS-CHANIKIAN

TABLE OF CONTENTS

CD OF POWER POINT PRESENTATION	SEPARATE
DESIGN CONCEPT	2
VISUAL RESEARCH AND CONCEPT SKETCHES	3
RENDERINGS	7
PHOTOS OF THE LIGHTING MOCK-UPS	10
LIGHTING PLAN	13
SECTIONS AND ELEVATIONS	15
BUDGET ESTIMATE AND EQUIPMENT SPECIFICATIONS	16

DESIGN CONCEPT



ENGAGING – FLEXIBLE – MAGICAL

THE INTENT OF THE DESIGN IS TO CREATE A FLEXIBLE, MULTI-PURPOSE LIGHTING SET-UP THAT ALLOWS FOR THE PORCH AND THE COMMUNITY CENTER TO BE USED FOR A VARIETY OF FUNCTIONS. ITS RANGE OF USES INCLUDES A COMMUNITY MARKET-PLACE, A QUIET AND SAFE ESCAPE, A VENUE FOR COMMUNITY FESTIVALS AND A PLACE FOR YOUTH TO GARDEN.

THE PORCH WILL BE A FUN AND COLORFUL BEACON ATTRACTING PEOPLE FROM ALL AROUND THE COMMUNITY AND BEYOND. THE GARDENS AND HOUSE WILL PROVIDE A BASE OF LIGHTING THAT WILL ENSURE THE SPACE IS LIT WELL ENOUGH FOR SAFETY AND TO FLATTER THE HOME AND GARDEN.

THE LIGHTING WILL CAPITALIZE ON THE GARDEN'S REPRESENTATION OF A GRADUAL BUT STEADY GROWTH TOWARDS A UNIFIED FLOURISHING COMMUNITY.

VISUAL RESEARCH AND CONCEPT SKETCHES

PORCH



VISUAL RESEARCH AND CONCEPT SKETCHES

PORCH

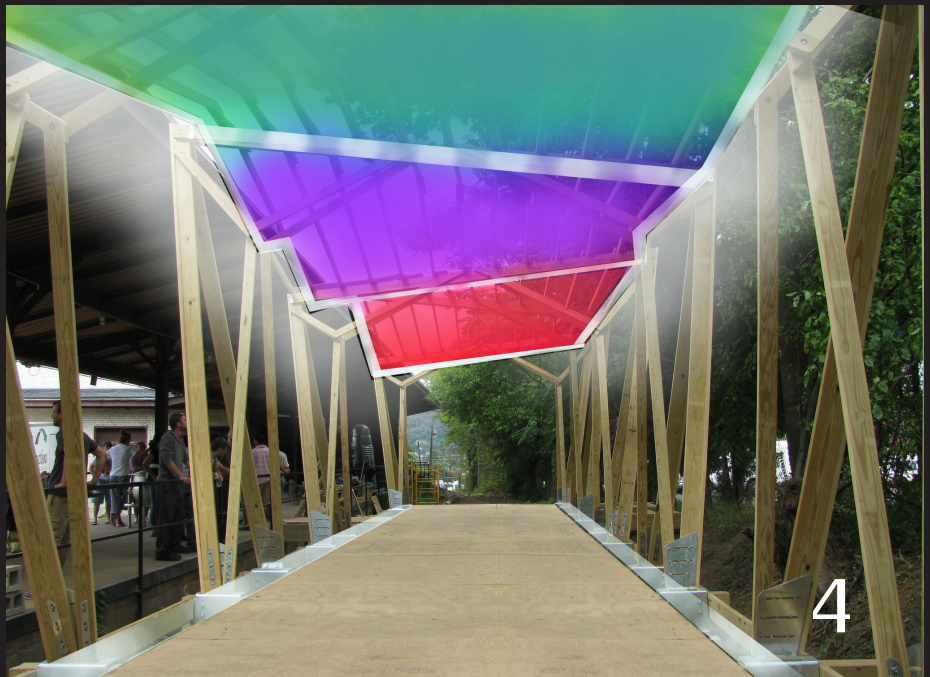
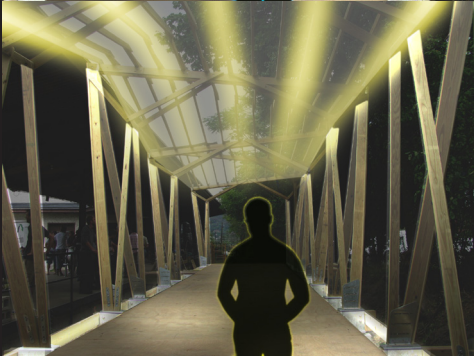
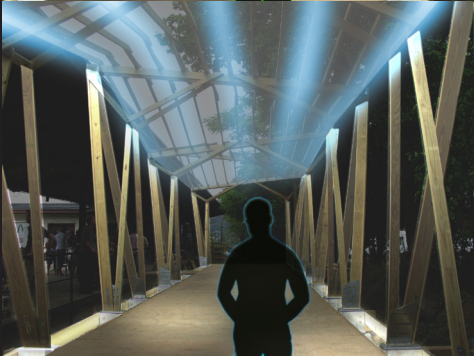
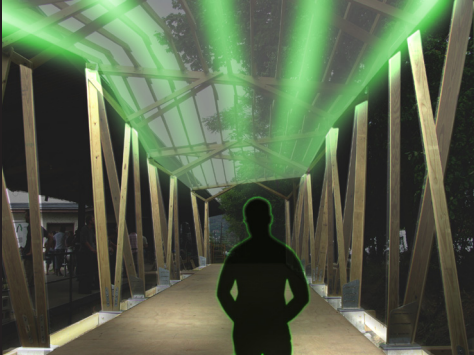
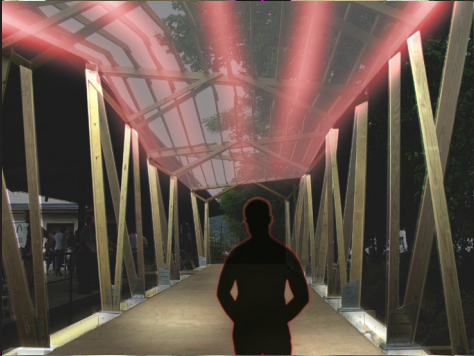
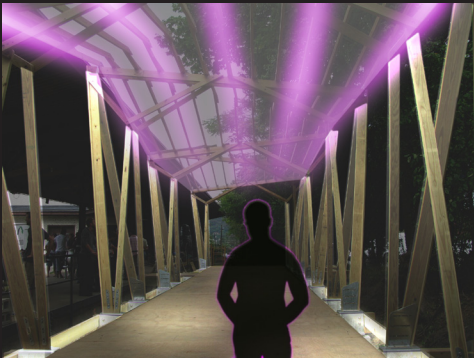

VISUAL RESEARCH AND CONCEPT SKETCHES

HOUSE



VISUAL RESEARCH AND CONCEPT SKETCHES

HOUSE AND TREES

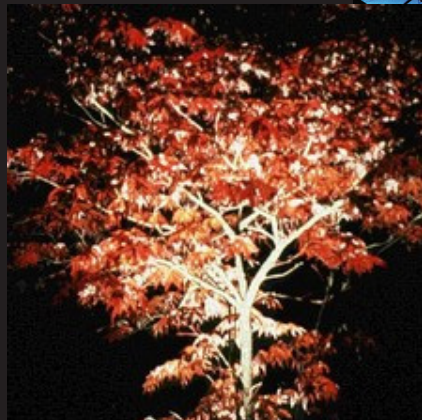
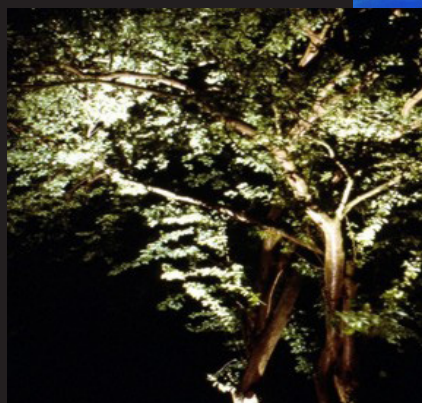

RENDERINGS





PHOTOS OF THE LIGHTING MOCK-UPS

PORCH

THE LED COLORBLAST UP LIGHTING CREATES AN EVEN WASH OF COLOR ACROSS THE CORRUGATED PLASTIC OF THE PORCH ROOF WHICH ACTS AS A FUN AND COLORFUL BEACON TO ATTRACT PEOPLE. THE COLORED LIGHTS CAN BE CHANGED TO ANY COLOR DEPENDING ON THE DESIRED FUNCTION, INCLUDING COLOR MIXING TO WHITE FOR MORE FORMAL EVENTS WHICH SO NOT REQUIRE ANY COLORED LIGHTING. THUS THE COLORBLAST LIGHTS PROVIDE AN EXTREMELY FLEXIBLE ENVIRONMENT ON THE PORCH.

A SECOND FAMILY OF LIGHTS SHINE DOWN FROM THE BEAMS OF THE PORCH AND WILL SERVE AS TASK LIGHTS. THESE LIGHTS ARE WHITE IN ORDER TO BEST ILLUMINATE PEOPLE AND PRODUCE AND TO ENSURE THAT THE PORCH FLOOR IS SAFELY LIT.

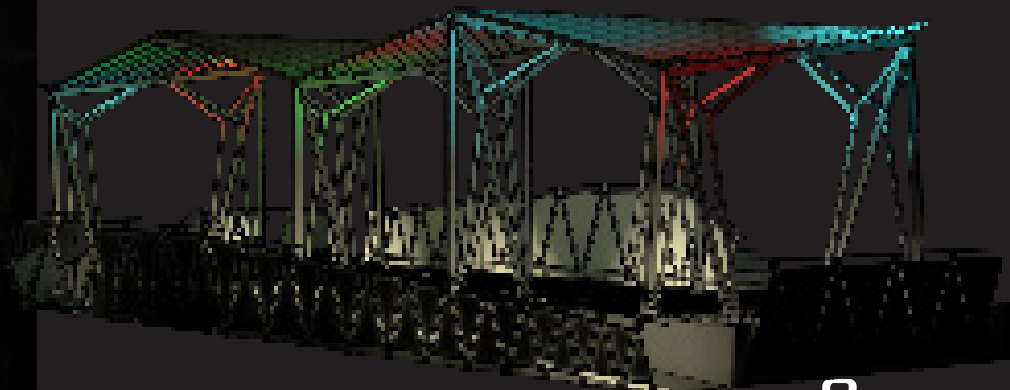
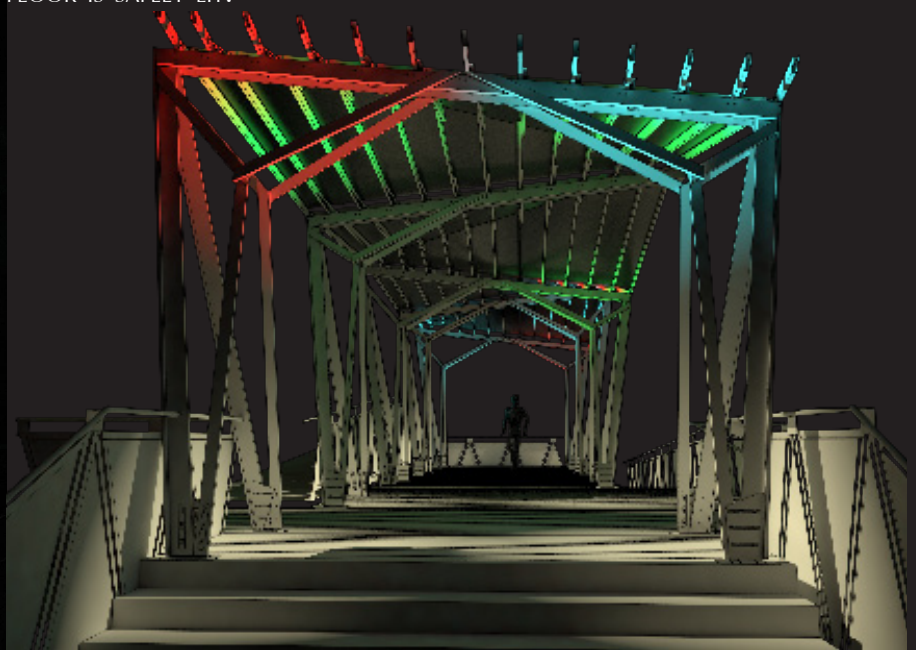
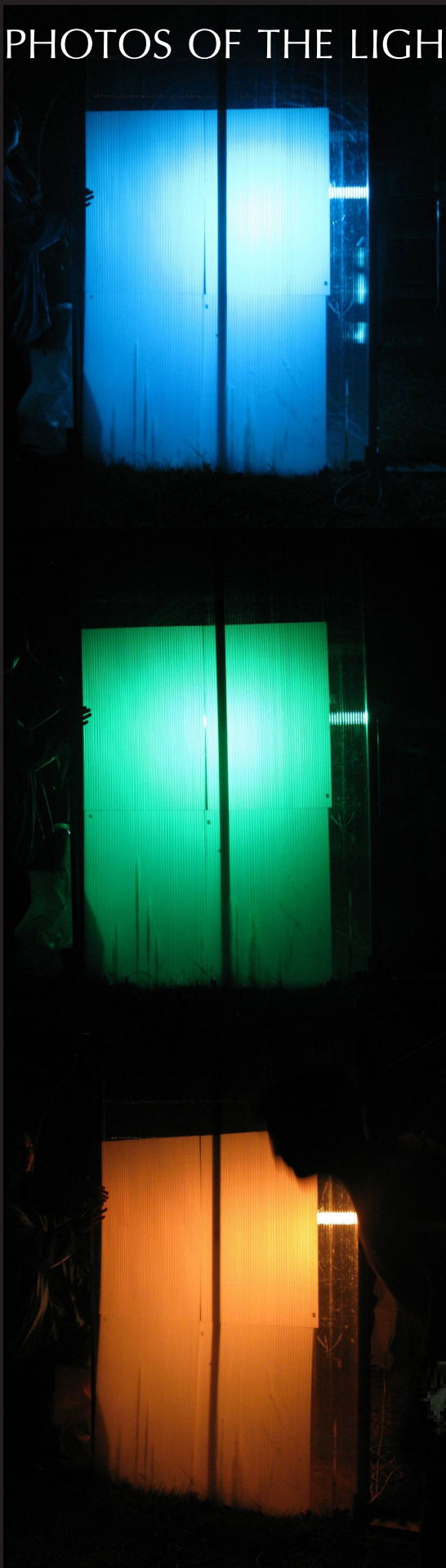

PHOTOS OF THE LIGHTING MOCK-UPS

HOUSE



THIS MOCK-UP SHOWS UP LIGHTING THE NORTH, WEST, AND EAST FACADES. THE COLOR BLAST LED LIGHTS ARE A FLEXIBLE LIGHTING STRATEGY ALLOWING FOR OPTIONS RANGING FROM TRANQUIL TO FESTIVE FOR THE MANY USES OF THE COMMUNITY AREA. AS SHOW IN THE LIGHTING MOCK-UP, THE DIFFERENT COLORS CREATE DIFFERENT MOODS WHILE STILL ACCENTUATING THE BEAUTIFUL ARCHITECTURAL ELEMENTS OF THE BUILDING.

PHOTOS OF THE LIGHTING MOCK-UPS

TREES



THIS MOCK-UP SHOWS COLORBLAST LED UP LIGHTING ON THE LARGE TREE SOUTH ON THE SITE AND WHITE LED UP LIGHTING ON THE GRANDFATHER TREE. THIS ALLOWS FOR FLEXIBILITY IN COLOR AT THE LARGE TREE FOR FESTIVITIES WHILE THE GRANDFATHER TREE PROVIDES AN ICON FOR THE COMMUNITY CENTER AND LIGHTING IN THE GARDEN AT NIGHT.



PHOTOS OF THE LIGHTING MOCK-UPS

TREES



EXAMPLE OF ENTRANCE TO THE COMMUNITY CENTER GARDEN



LARGE TREE VISIBLE FROM THE CENTER AVENUE.

THIS TREE WHEN COLORED WITH LED UP LIGHTING WILL GRAB ATTENTION AND CREATES INTEREST IN THE ACTIVITIES GOING ON IN THE COMMUNITY CENTER.

LIGHTING PLAN: SCHEME 1

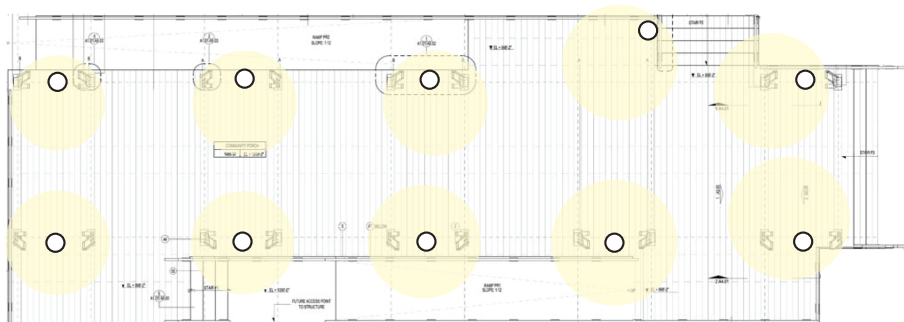
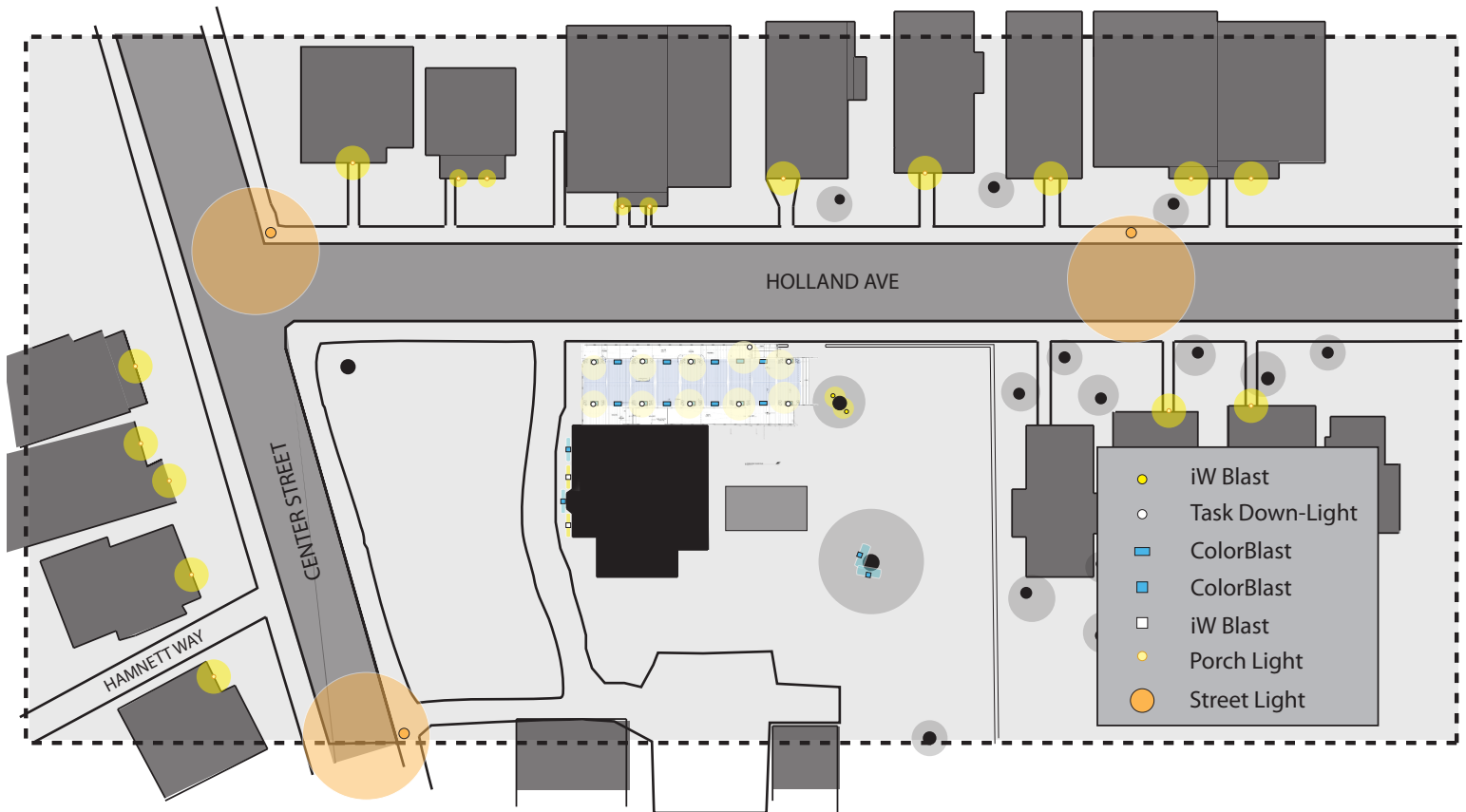

THIS IS THE IDEAL LIGHTING SCHEME FOR THE SITE. THIS SCHEME LIGHTS THE WEST FACADE OF THE HOUSE WITH BOTH COLOR AND WHITE LIGHT, THE PORCH WITH BOTH COLOR AND WHITE LIGHT, THE GRANDFATHER TREE WITH WARM WHITE LIGHT AND THE LARGE SOUTH TREE WITH COLOR.

THIS SCHEME ALLOWS FOR AN EXTREMELY FLEXIBLE LIGHTING ENVIRONMENT THAT CAN RANGE FROM FESTIVE TO CALM.

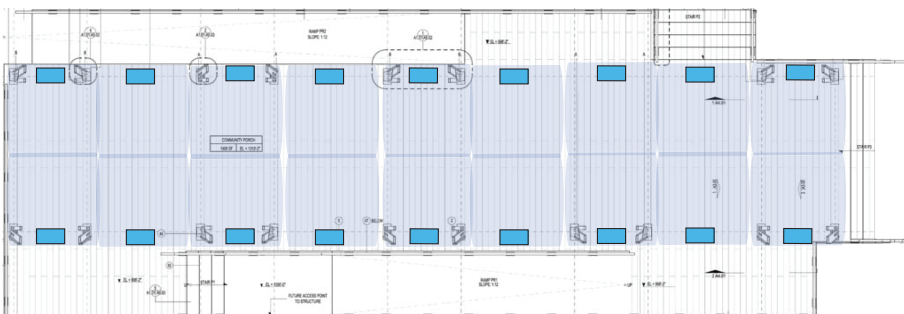

LIGHTING PLAN: SCHEME 2

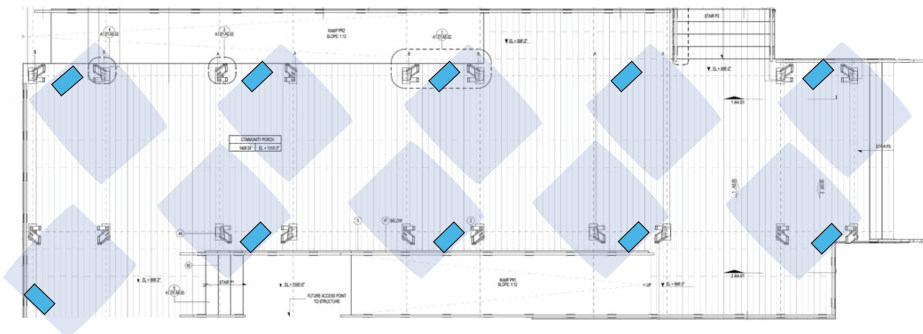
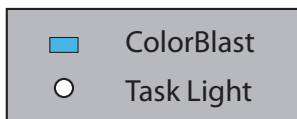
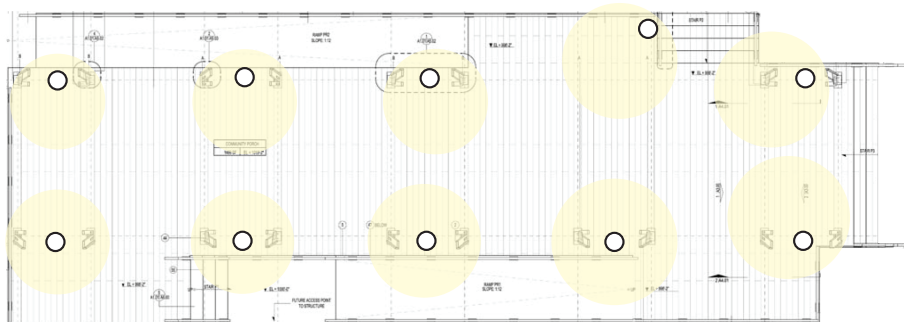
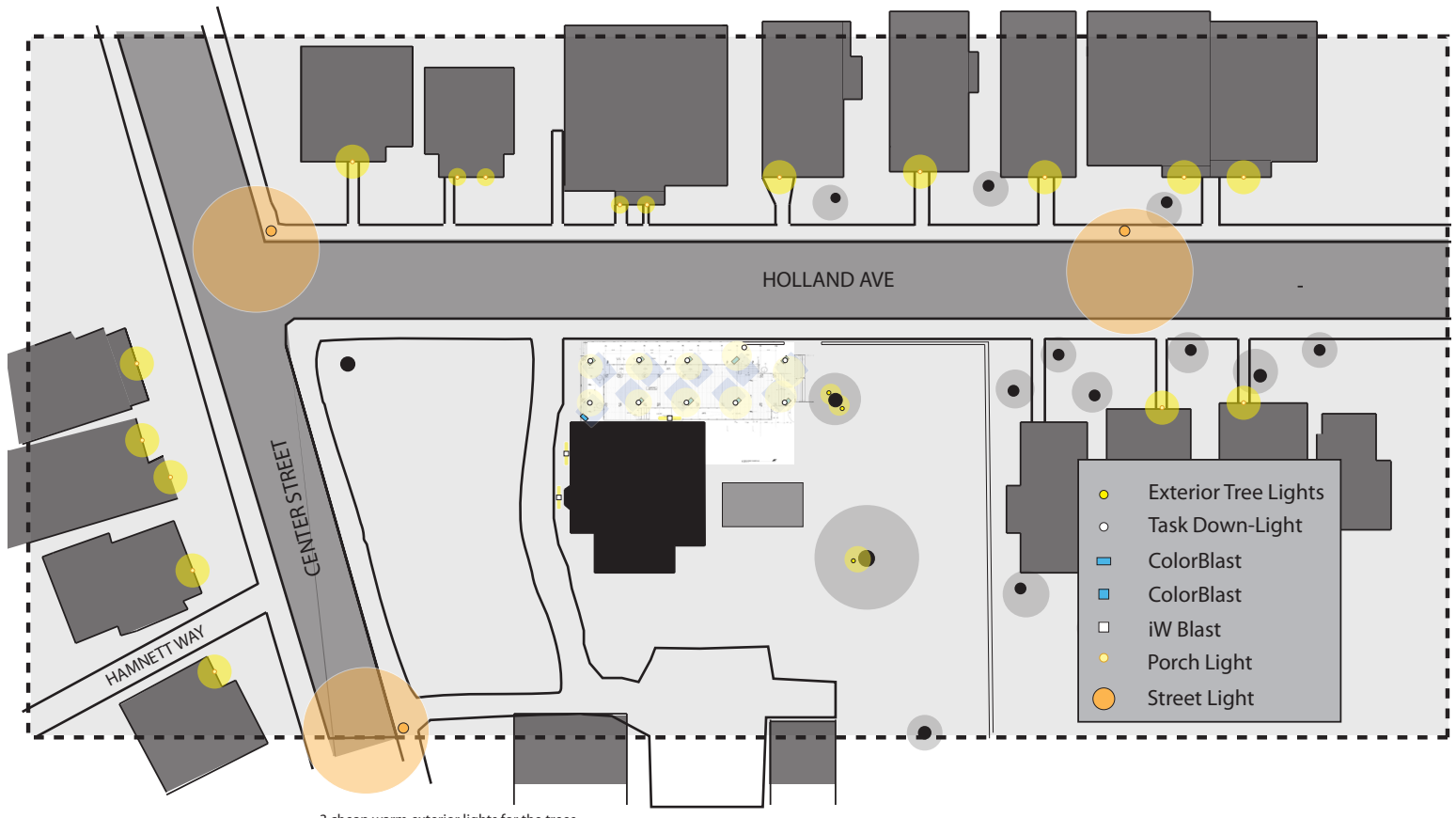

THIS IS THE SECOND BEST LIGHTING SCHEME THAT WILL ALLOW FOR A SIMILARLY FLEXIBLE ENVIRONMENT RANGING FROM FESTIVE TO CALM, EXCEPT THIS SCHEME FOCUSES MOST OF ITS EFFORTS ON THE PORCH. AS THE MAIN ENTRY AND MARKETPLACE FOR THE COMMUNITY CENTER, THE PORCH HAS COLOR LIGHTS ALTERNATING DIAGONALLY ACROSS THE WHOLE ROOF IN ORDER TO KEEP IT AS A BEACON AND FOCAL POINT FOR THE COMMUNITY CENTER. THE GRANDFATHER TREE AND LARGE TREE IN THE SOUTH ARE ALSO UP LIT USING MORE INEXPENSIVE LIGHTING TO PROVIDE LIGHTING FOR THE GARDEN AT NIGHT AND KEEP THE GRANDFATHER AS AN ICON OF THE SITE. THE HOUSE IS UP LIT WITH WHITE LEDs ON THE WEST FACADE EMPHASIZING THE ARCHITECTURAL ELEMENTS OF THE BUILDING.

SECTIONS AND ELEVATIONS

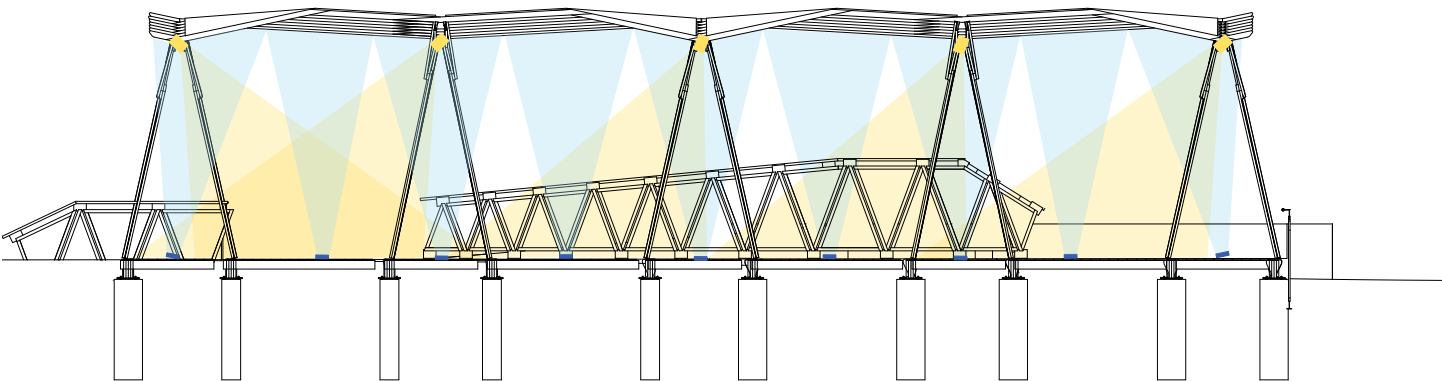

N-S SECTION

THE SECTIONS SHOW THE ANGLES AND PLACEMENTS OF LIGHTS USED IN THE FIRST AND BEST OPTION. LEDs WITH A SPREAD OF 22 DEGREES SHINE FROM THE FLOOR OF THE PORCH ONTO THE ROOF AND REFLECT LIGHT BACK DOWN. TASK LIGHTS ARE LOCATED AT THE INTERSECTIONS OF THE PORCH BEAMS AND ROOF AND SHINE WHITE LIGHT ONTO THE FLOOR AND ACTIVITIES ON OF THE PORCH.

E-W SECTION

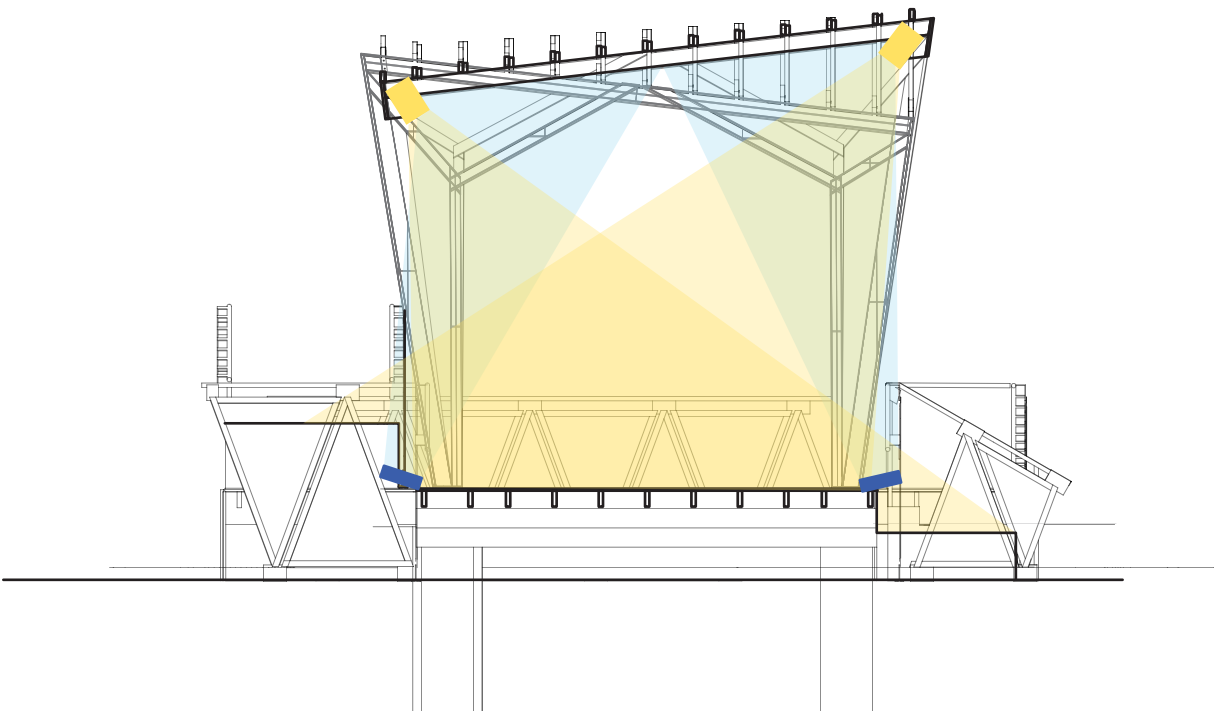

BUDGET ESTIMATE FOR EQUIPMENT PACKAGE

FIXTURE	PRICE	QUANTITY	TOTAL
---------	-------	----------	-------

SCHEME 1

IW blast	\$800	4	\$3,200
Color blast 12	\$900	24	\$21,600
SC 9 star LED light	\$70	10	\$700
DE power supply	\$149	8	\$1,192
I player 3 controller	\$1,200	1	\$1,200
			\$27,892

SCHEME 2

IW blast	\$800	3	\$2,400
Color blast 12	\$900	10	\$9,000
RAB flood light	\$35	3	\$105
SC 9star LED light	\$70	10	\$700
DE power supply	\$149	4	\$596
I player 3 controllers	\$1,200	1	\$1,200
			\$14,001



